

QUO CARD is a line of gift cards that can be used at familiar stores throughout Japan.



Anyone can use QUO CARD with confidence *anytime, anywhere.*



Payment via QUO CARD is possible at any store where you see this sticker. Please show the card to the cashier upon payment.

Stores where QUO CARD can be used (partial list / current as of May 2026)

QUO CARD can be used at a wide variety of places, including convenience stores, book stores, and drug stores.

* Excludes some stores

The number of QUO CARD member stores will fluctuate. Please check the latest list of member stores here.

<https://www.quocard.com/individual/store/quocard/>



QUO CARD user guide

- Payments of the following cannot be made via QUO CARD: public fees, prepaid cards, revenue stamps, postage stamps, cigarettes, tickets, or payments for products for which the publisher/dealer has specified such cards are not valid.
- The remaining balance of the card can be checked via receipts or the hole punched in the card.
- If the remaining QUO CARD balance (remaining amount) is not sufficient, please combine the card with cash to make the payment. You may also combine the card with another card of the same type to pay.
- Products purchased with QUO CARD cannot be returned.
- Currently issued QUO CARD cards do not have an expiration date.
- Do not bend the card, get it dirty, or put it in close contact with magnets.
- QUO CARD can only be used in Japan.
- The terms of the QUO CARD service are written in Japanese, and this service is governed by Japanese law.

Please take good care of your purchased card.

Magnetic information is recorded on the card.

Sometimes the card cannot be used properly because of a magnetic failure, deformation, or dirt on the card. Please refrain from using it in a way that adversely affects the card media or magnetic information.

*** Sometimes the card cannot be used at a store for the following reasons.**

Do not let the card get close to items with magnetic force.

* Keeping the card with other cards such as credit cards will not pose a problem.

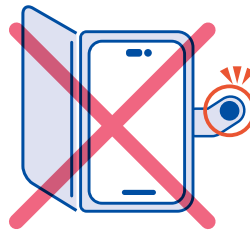

Smartphone cases

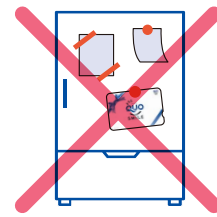

Refrigerators
(Magnets and magnet sheets)

Do not bend the card, cut it, or get it dirty.

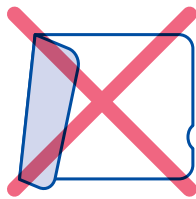

Bend

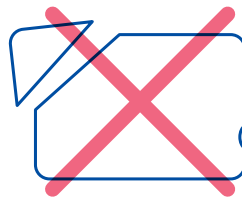

Cut



Dirt

Do not put stickers or tape on the card, and do not write letters with ink on either side of the card.

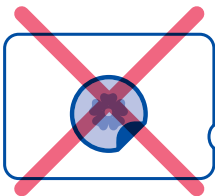

Stickers

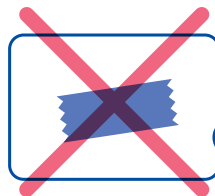

Tape



Writing



If you cannot use QUO CARD or encounter a problem, please check here.

<https://www.quocard.com/caution/unavailable/>

* Unfortunately, operators at our inquiry desk can only respond in Japanese.

